

PC Plus

- RF Shield provides superior RFI/GSM shielding.
- Dual Capsule Design with four polar patterns: omnidirectional, cardioid, supercardioid, and hypercardioid.
- Configurable push-button switch with status LED.
- XLR mounted or flush mounted.
- Available in 12, or 18-inch versions.



The PolarChoice PC-Plus is the first miniature gooseneck microphone to combine the features and functionality of a desktop mic, with the small unobtrusive size of an XLR mounted gooseneck microphone.

The unique profile of the PC-Plus housing places the push button switch and status LED in a more natural position and also creates a lower profile housing. You can even go one step further: the lower half of the PC-Plus (with XLR connector) can be removed and the PC-Plus can be flush mounted. Electro-Voice supplies all the necessary mounting hardware.

The push-button can be configured for either toggle (push on/off), or as PTT or PTM. You can also configure the microphones' state when power is first applied in toggle mode. So, for example, if you have an installation with multiple PC Plus microphones, you can configure them so that only one mic is live, when the system is first turned on.

The PC-Plus is also an EV PolarChoice multi-pattern microphone, and is highly shielded from RFI/GSM thanks to EV's exclusive RF Shield technology. The multi-pattern versatility of the PolarChoice microphone makes it true "problem solver". With 3 directional and one non-directional polar pattern available, the PolarChoice microphone is ideal for virtually any installation.

The PC-Plus also includes a switchable high pass filter that greatly reduces any vibration induced noise pickup. All configuration controls are only accessible from the "bottom" of the microphone, reducing the chances of inadvertent changes.

Altering the polar pattern does not change the on-axis sonic character of the microphone. Therefore, changes in equalizer settings are unnecessary. The PolarChoice

PC Plus is acoustically designed for high-quality sound reinforcement and broadcast applications. The frequency response is tailored for wide-range sound reproduction with very natural sound pick-up for either distant or close-up use.

The small, dual diameter gooseneck has two supple joints (12 and 18-inch versions) and a rigid center tube. The rigid tube prevents unsightly twisting of the gooseneck but permits the user to exactly position the microphone. The PolarChoice PC Plus is designed to be phantom-powered with a wide voltage range of 12-52VDC (DIN Standard 45 596).

Technical specifications

Generation element:	Dual condenser, back-electret
Frequency response:	50Hz to 20,000Hz (see chart)
Polar patterns: (see chart)	Omnidirectional Cardioid Supercardioid Hypercardioid
Switches and controls:	Top mounted momentary push-button Push on/off, or PTT/PTM selector Power up on/off selector High pass enable 4-position polar pattern selector
Sensitivity:	Open circuit voltage, 1kHz: 5.6mV/Pascal
Clipping level (1% THD):	>127dB SPL
Equivalent noise:	<26dB SPL "A" weighted (0 dB=20 microPascals)
Dynamic range:	>101dB

Output impedance, 1 kHz:	200 Ohms
Power requirements:	Phantom, 12-52VDC
Current consumption:	<5mA with P48 supply
Polarity:	Pin 2 positive, referenced to Pin 3, with positive pressure on the diaphragm
Dimensions:	Gooseneck length: PC Plus-12: 305 mm (12 in) PC Plus-18: 457 mm (18 in) Maximum head diameter: 14.6 mm (0.58 in) Gooseneck diameter: Lower section, 7.9 mm (0.31 in) Upper section, 6.4 mm (0.25 in)
Accessories furnished:	Windscreen Two-piece shock mount Flush mount parts kit
Optional accessories:	FMK flange-mount kit WS-PC1 large windscreen CPSM shock-mount kit
Color:	Non-reflecting black
Shipping weight:	PC Plus-12: 201 grams (7.1oz) PC Plus-18: 210 grams (7.4oz)

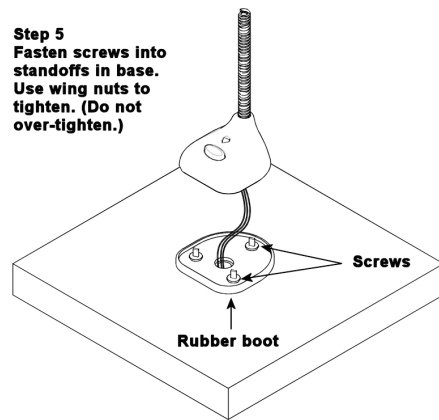
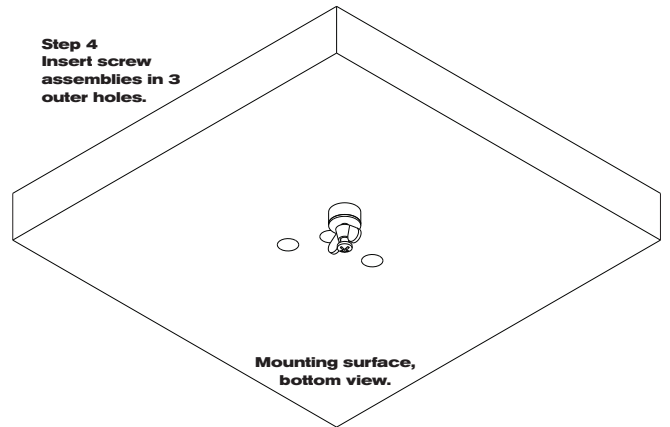
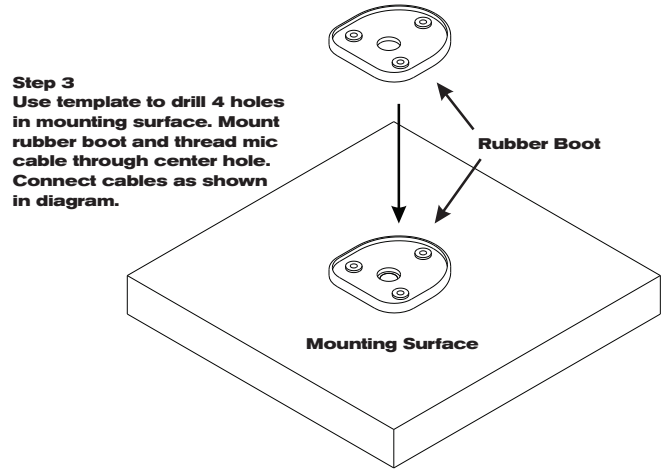

Surface mounting the PC Plus microphone

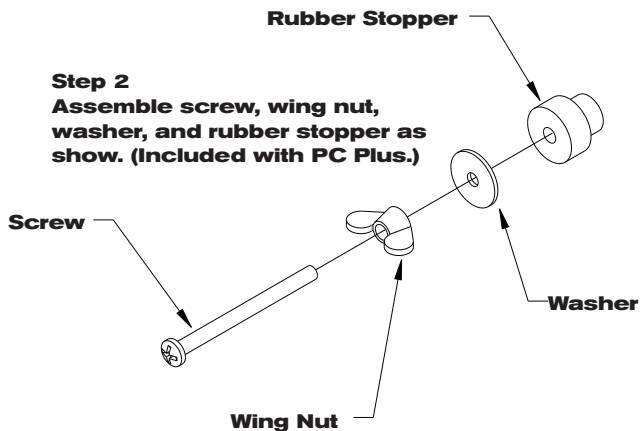
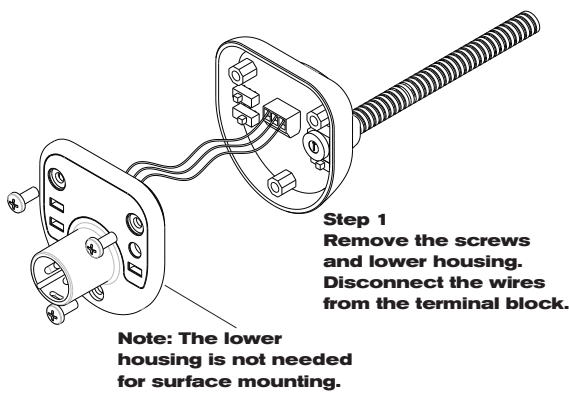

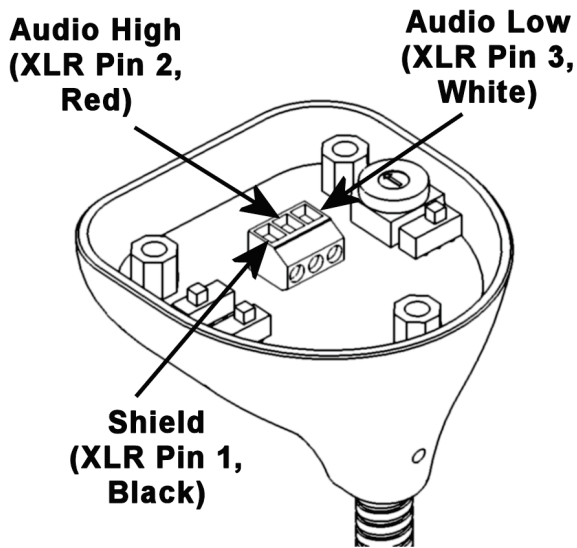

Wiring Diagram

Applications

The PolarChoice PC Plus can be used on lecterns, podiums, desk and table-tops, or other applications which require a quick plug-in gooseneck microphone. For permanent installations, the PC Plus can also be easily flush mounted.

To maximize gain-before-feedback the PolarChoice's three directional polar patterns allow the user to pick the directional polar pattern for optimum effect. For those applications where gain-before-feedback is not a problem, an omnidirectional pattern is included. Applications requiring speaking close to the microphone at podiums, lecterns, or pulpits normally require a windscreen (included) to control breath noise and P-popping or, in some cases, wind noise from circulating air.

EV Multi-Port Windscreen

All Polar Choice microphones come with the exclusive EV Multi-Port Windscreen. This unique one piece ported design offers greatly improved resistance to "P"- popping noise by creating a two-stage filter that has an air space between the stages. This makes the multi-port windscreen as effective as much larger traditional designs.

Architects' and Engineers' Specifications

The microphone shall be a back-electret condenser type with a frequency response of 50 Hz to 20 kHz. The microphone shall produce a high degree of output signal quality despite the possible near-field presence of RF (Radio Frequency) devices such as cell phones. The microphone shall have a nominal, balanced output impedance of 200 Ohms. The microphone shall have four selectable polar patterns: omnidirectional, cardioid, supercardioid, and hypercardioid. The microphone shall have an output level of 5.6 mV/Pascal, and outputs shall not be appreciably affected by the following temperature and humidity extremes: -29 °C to 74 °C (-20 °F to 165 °F) when the relative humidity is 0 to 50 %; -29 °C to 57 °C (-20 °F to 135 °F) when the relative humidity is 0 to 95 %. Dimensions shall be 363 mm (14.3 in) long (PC Plus-12), and 516 mm (20.3 in) long (PC Plus-18), with a maximum head diameter of 14.6 mm (0.58 in). The PC Plus-12 microphone shall include a 305 mm (12 in) gooseneck. The PC Plus-18 microphone shall include a 457 mm (18 in) gooseneck. The gooseneck will be attached to a miniature base that has a top mounted push-button, and a status LED that lights when audio is active. The push-button will be configurable for push on/off, or push-to-mute/push-to-talk operation. Furthermore, when the push-button is set for push on/off operation, the status of the microphone when power is initially applied will be configurable. The miniature base will have an integral 3-pin XLR connector. The lower section housing of the miniature base will be removable to facilitate flush mounting of the microphone on a flat surface and appropriate hardware will be supplied for this purpose. The microphone will have a switchable high pass filter to roll off low frequencies. All controls except for the push button will be only accessible from the bottom of the microphone base. The microphone shall be of metal construction. The microphone will include external windscreen. The microphone shall have a nonreflecting black finish. The Electro-Voice PolarChoice PC Plus-12, or PC Plus-18 is specified.



Frequency response

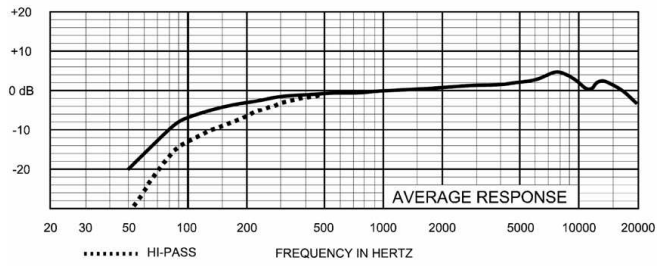

Polar response

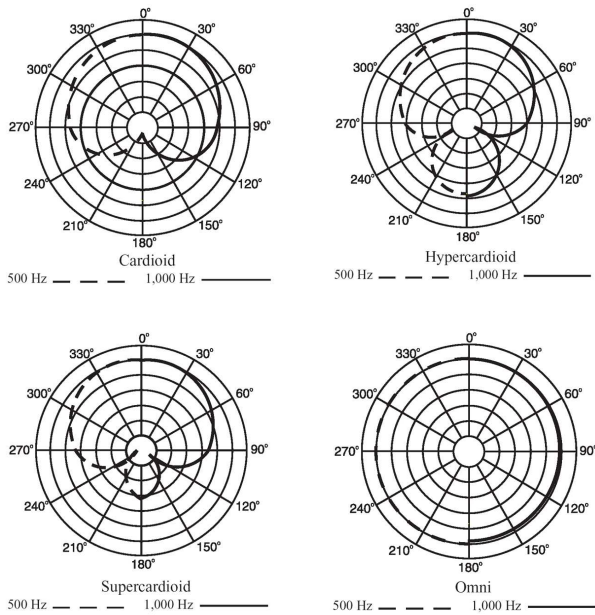

Dimensions

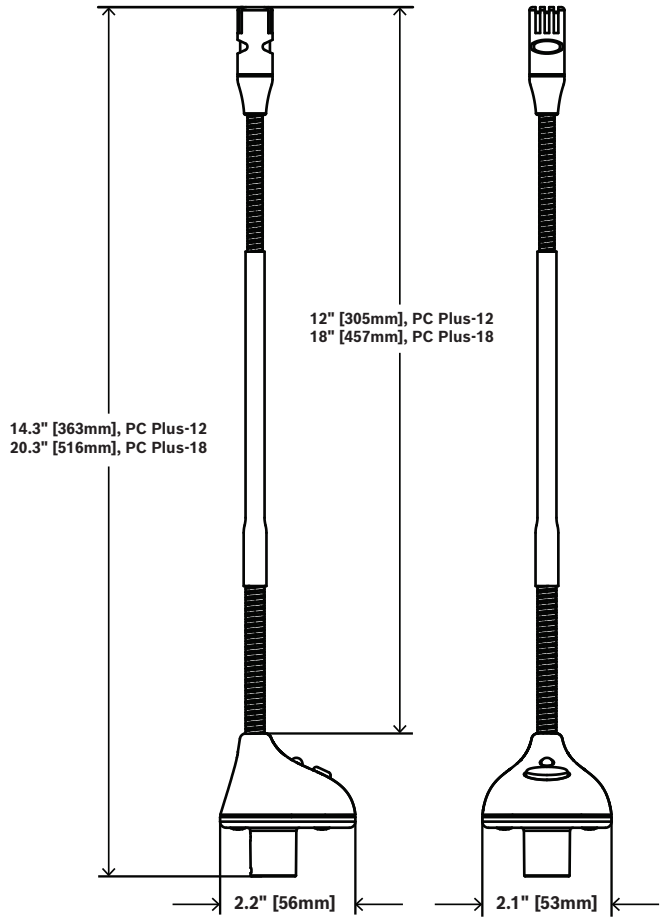

PC Plus controls

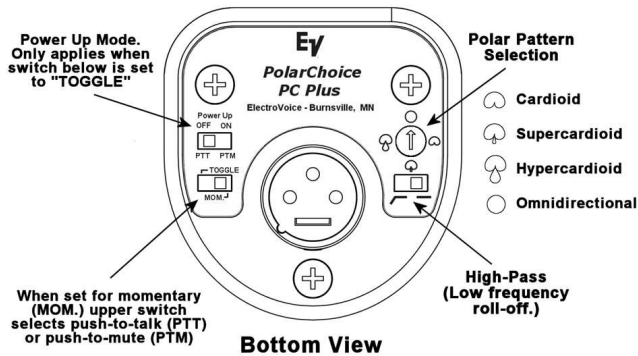

Warranty

For information on warranty periods and after sales service, please visit: www.electrovoice.com/warranty

Ordering information

PC PLUS-12 Gooseneck microphone, 12"
 12-inch PolarChoice series podium microphone, including On/Off switch
 Order number **PC PLUS-12 | F.01U.117.615**
F.01U.411.907

PC PLUS-18 Gooseneck microphone, 18"
 18-inch PolarChoice series podium microphone, including On/Off switch
 Order number **PC PLUS-18 | F.01U.117.614**
F.01U.410.842

Represented by:

Germany:
 Bosch Sicherheitssysteme GmbH
 Robert-Bosch-Ring 5
 85630 Grasbrunn
 Germany
www.electrovoice.com

Bosch Security Systems, LLC
 12000 Portland Avenue South
 Burnsville MN 55337
 USA