

TX2152 Dual 15" 2-Way Passive Full-Range Loudspeaker

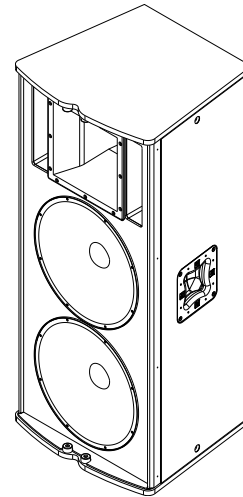

Electro-Voice

- ND2-8 2" (51 mm) Diaphragm, 1" (25.4 mm) Exit Neodymium Compression Driver
- Dual SMX2151 15" (381 mm) LF Transducers with Fully Symmetric Drive
- 60° x 40° Rotatable Coverage Pattern
- 103 dB Sensitivity, 139 dB Maximum SPL
- 1000 W Continuous (4000 W Peak) Power Handling



The TX2152 from Electro-Voice is a high power, very high sensitivity, 2-way loudspeaker system that can be used in applications that require high SPL while maintaining a smooth response. When combined with the TX2181 subwoofer, the TX2152 is capable of serving as the main PA for small to medium sized live sound venues and nightclubs with extended LF response.

The TX2152 utilizes the ND2, a high output 2-inch titanium compression driver, coupled to a Constant Directivity 60° x 40° horn. This combination results in excellent pattern control in medium throw applications. Dual SMX2151 15-inch woofers have FEA optimized magnet structures and shorting rings for ultra low distortion and maximum intelligibility at high SPL levels. The crossover uses very steep 36 dB/octave slopes with equalization for very smooth response in vocal range, and a protection circuit for long term reliability. The TX2152 has a variety of features that make it equally suited for portable or fixed installation applications. The internally braced, trapezoidal enclosure is constructed out of a combination of plywood and MDF, and coated with EVCoat for maximum strength and durability. The unique grille design is very strong, dent resistant, and features a rotatable logo. Four way handles allow for gripping the TX2152 in a variety of positions. Six (6) M10 threaded points allow a single TX2152 to be suspended in a various positions in fixed installation applications. The recessed input panel with dual NL4 connectors keeps the connectors hidden and allows for closer placement to a wall or other boundary. The TX2152 is the same width and height as the TX2181, providing a single column appearance when stacked, and uses the minimum amount of space when stored or transported.

Parts included

Quantity	Component
1	Loudspeaker
1	User manual

Technical specifications

Frequency response (-3 dB):	55 Hz - 13 kHz ¹
Frequency range (-10 dB):	50 Hz - 18 kHz ¹
Recommended high-pass frequency:	40 Hz
Axial sensitivity:	103 dB (1W/1m)
Max calculated SPL:	139 dB
Horizontal coverage:	60° or 40°
Vertical coverage:	40° or 60°
Power handling:	1000 W continuous, 4000 W peak
LF transducer:	(2) SMX2151's, 15 in (381 mm) drivers
HF transducer:	ND2-8, 2 in (51 mm) diaphragm compression driver
Crossover frequency:	1750 Hz
Nominal impedance:	4 Ohm
Minimum impedance:	3.1 Ohm
Connectors:	(2) Neutrik Speakon NL4's
Enclosure:	Plywood and MDF with EVCoat
Grille:	16 GA steel, black powdercoat, with rotatable logo
Suspension:	(6) M10 threaded points - (2) on each side and (2) on the rear of enclosure
Color:	Black
Dimensions (H x W x D):	45.4 in x 20.0 in x 18.5 in (1154 mm x 508 mm x 471 mm)
Net weight:	94.3 lb (42.8 kg)
Shipping weight:	105.8 lb (48.0 kg)

¹Full half space measurement

Frequency response and impedance:

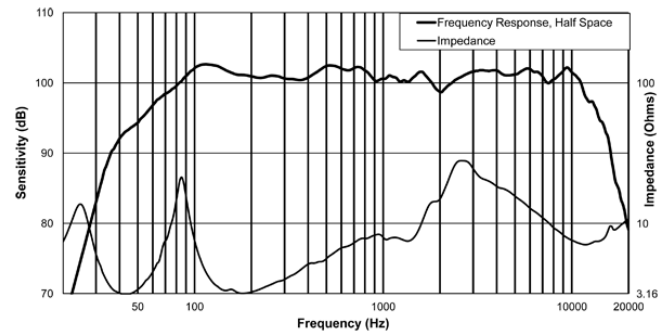

Block diagram:

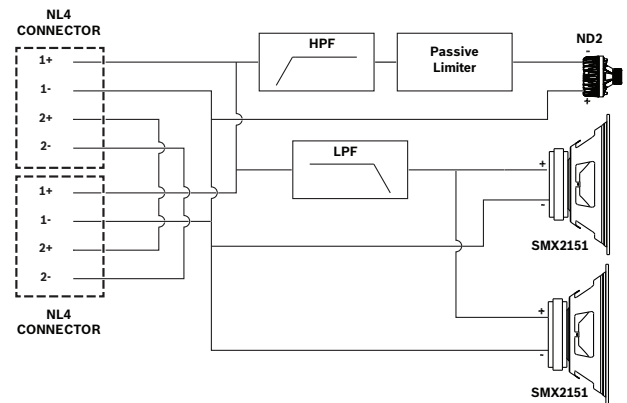

i Notice

Electro-Voice loudspeakers and rigging accessories should be suspended overhead only in accordance with the procedures and limitations specified in the user documentation and installation manual. Electro-Voice products should be suspended with certified rigging hardware by an authorized rigging professional and in complete compliance with local, state, and federal overhead suspension ordinances.

Compatible System Solutions:

TX2181 Dual 18" passive subwoofer, black

Dynacord L3600FD DSP power amplifier 2 x 1800 W

Dynacord C3600FDi DSP power amplifier 2 x 1800 W, install

Dimensions:

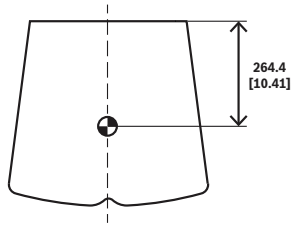

 = Center of gravity

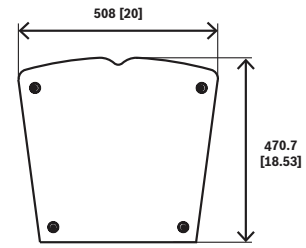
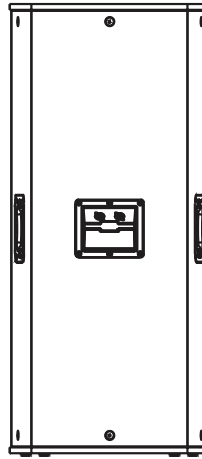
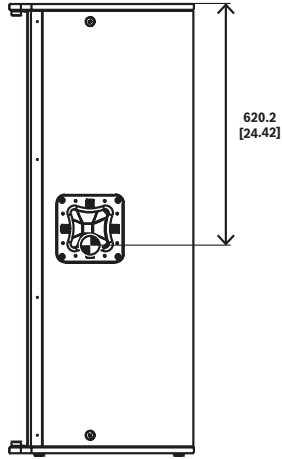
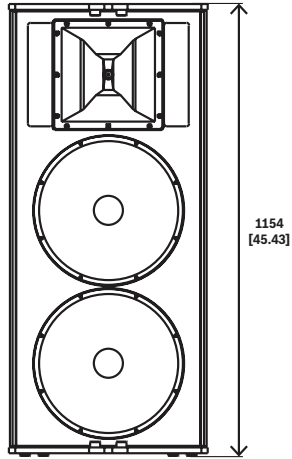

mm[inch]

Ordering information

TX2152_HE Dual 15" 2-way passive speaker, black
2 x 15" 2-way Full-range, 103 dB, 1000 W cont., black
Order number **TX2152_HE | F.01U.302.274**

EBK-M10-3PACK Forged M10 3 pack eyebolt kit
Forged M10 eyebolt kit, set of 3
Order number **EBK-M10-3PACK | F.01U.301.455**

EBK-M10-4PACK EBK-M10-4PACK Eyebolt Kit
Forged M10 eyebolt kit, set of 4
Order number **EBK-M10-4PACK | F.01U.346.745**

Represented by:

Germany:
Bosch Sicherheitssysteme GmbH
Robert-Bosch-Ring 5
85630 Grasbrunn
Germany
www.electrovoice.com

Bosch Security Systems, LLC
12000 Portland Avenue South
Burnsville MN 55337
USA