

ETX-15SP Powered Subwoofer

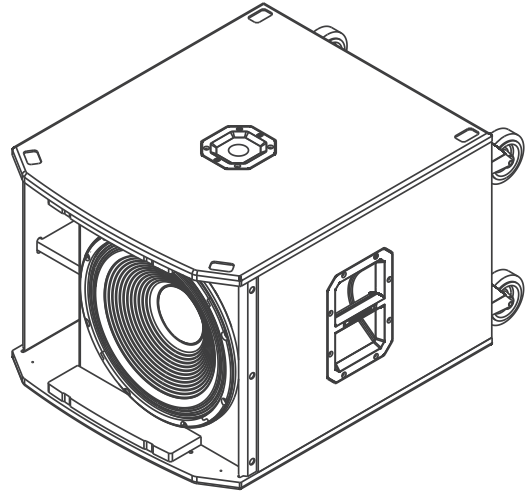

- 1800 W amplifier and 134 dB peak SPL
- Single-knob DSP includes presets for multiple configurations and top+sub combinations (performance style, locations, and space)
- Loudspeaker system performance monitoring via integrated LCD and front panel LED
- Includes DSP preset for true cardioid performance
- Enclosure includes removable casters and a combo pole cup (insert and threaded) for use with the two-way models



ETX-15SP from Electro-Voice is a powered subwoofer; it can be used in a variety of portable and permanent applications. The DSP (Digital Signal Processing) menus offer extensive configurations, crossovers, true cardioid presets, protection limiters, EQ mode, and a lock out mode that prevents casual changes to the system. Loudspeaker system performance is optimized via an LCD screen. The front LED indicates power or can be configured to indicate limit.

EV's FIR-Drive technology utilized the latest FIR (Finite Impulse Response) filter technology to optimize transducer linearity and advanced limiter algorithms for independent peak and thermal transducer protection. True cardioid DSP preset delivers true cardioid response across all frequencies.

The enclosure is constructed out of 18-mm plywood finished with EVCoat. Subwoofers include professional-grade castors, and combination pole mount receptacle for threaded and unthreaded loudspeaker poles.

ETX Powered Loudspeakers combine EV-engineered intelligent DSP, high-powered amplifiers and high-efficiency transducers to deliver that legendary EV sound and performance.

System overview

Subwoofer amplifier panel:

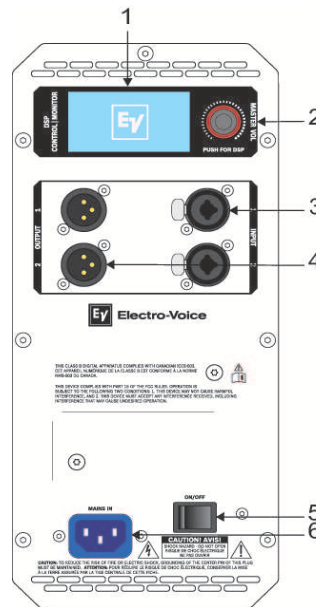

1. LCD
2. MASTER VOL/DSP
3. INPUT
4. OUTPUT
5. POWER
6. MAINS IN

Technical specifications

Frequency response (-3 dB):	37 Hz - 150 Hz¹
Frequency range (-10 dB):	32 Hz - 180 Hz ¹
Maximum SPL:	134 dB peak ²
Power rating:	1800 W
LF transducer:	DVX3159A 380 mm (15 in)
Low pass frequency:	Adjustable: 80 Hz, 100 Hz, 120 Hz, 150 Hz
Connectors:	(2) XLR/TRS Combo Jack and (2) XLR link Output
Enclosure:	18 mm plywood with EVCoat
Grille:	16AWG steel with powdercoat
Color:	Black
Dimensions (H x W x D):	471 mm x 576 mm x 825 mm (19 in x 23 in x 32 in)
Dimensions (H x W x D)	471 mm x 576 mm x 692 mm without casters: (19 in x 23 in x 27 in)
Net weight:	41.7 kg (91.9 lb)
Shipping weight:	46.8 kg (103.2 lb)

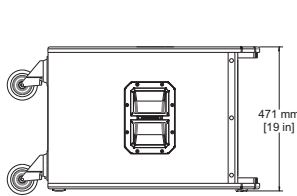

Left View

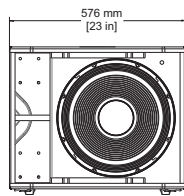

Front View

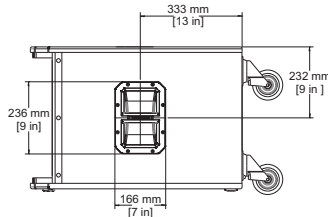

Right View

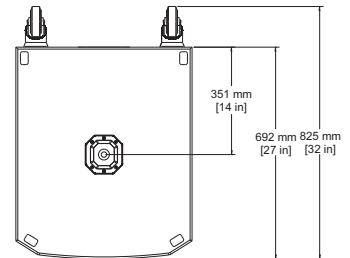

Top View

Frequency response (-3 dB): 37 Hz - 150 Hz¹

Power consumption: 100 - 240 V~, 50 - 60 Hz, 1.6 - 0.8 A³

¹Half space measurement using the music DSP preset and 150 Hz low pass.

²Maximum SPL is measured at 1 m using broadband pink noise at maximum amplifier output.

³Current rating is 1/8 power.

Frequency response:

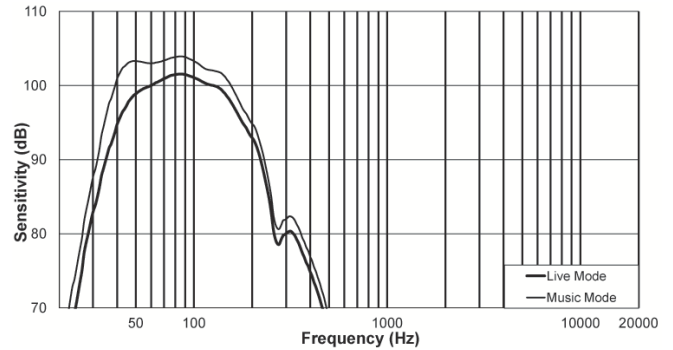

Dimension drawing:

Ordering information

ETX-15SP-US ETX-15SP POWERED SUBWOOFER, BLK, US

15-inch powered subwoofer, black, US 120V

Order number **ETX-15SP-US | F.01U.289.238**

ETX-15SP-EU 15" powered subwoofer, EU cord

15-inch powered subwoofer, black, EU 240V

Order number **ETX-15SP-EU | F.01U.289.239**

F.01U.396.744

Accessories

ETX-15SP-CVR Padded cover for ETX-15SP, EV logo

Padded cover for ETX-15SP, EV logo

Order number **ETX-15SP-CVR | F.01U.297.638**

Represented by:

Germany:
Bosch Sicherheitssysteme GmbH
Robert-Bosch-Ring 5
85630 Grasbrunn
Germany
www.electrovoice.com

Bosch Security Systems, LLC
12000 Portland Avenue South
Burnsville MN 55337
USA